







Measurement Data Management



Convenient data collection tool and quality control software

Digimatic Data Cable Selector (including USB Input Tool Direct)

USB Input Tool Direct USB-ITN 	Connector type		(A) Water-proof type with output button	(B) Water-proof type with output button	(C) Straight type with output button	(CR) L type with output switch (cable outlet is right)
	Model No. Order No.		USB-ITN-A 06AFM380A	USB-ITN-B 06AFM380B	USB-ITN-C 06AFM380C	No applicable models USB-ITN-C is available Refer to the following figure.
IT-016U/IT-007R/DP-1VA LOGGER/MUX-10F/ EC Counter 	Connector type		(A) Water-proof type with output button	(B) Water-proof type with output button	(C) Straight type with output button	(CR) L type with output switch (cable outlet is right)
	Order No.	1 m	05CZA624	05CZA662	959149	04AZB512
		2 m	05CZA625	05CZA663	959150	04AZB513
U-WAVE-T 	Connector type		(A) Water-proof type with output button	(B) Water-proof type with output button	(C) Straight type with output button	(CR) L type with output switch (cable outlet is right)
	Standard		02AZD790A	02AZD790B	02AZD790C	No applicable models Type C connectors are available, but take care of the cable when using thimbles Refer to the following figure.
	For foot switch		02AZE140A	02AZE140B	02AZE140C	

Select a cable (A to G) whose gage connector fits the Digimatic port on your gage (check the red dotted frame in the above pictures).

Gage connectors on data cable The connector dimensions are given on page A-27.	Connector type		(A) Water-proof type with output button	(B) Water-proof type with output button	(C) Straight type with output button	(CR) L type with output switch (cable outlet is right)
	Picture of gage connector					
	Data switch		Available	Available	Available	Available

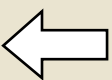
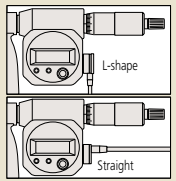
Digimatic ports on gage Please note that some high-precision Digimatic gages are capable of displaying the measurement result to more than 6 digits. However, according to the Digimatic output specification, the result may be output in 6 digits only. Digimatic gages whose display may exceed 6 digits <ul style="list-style-type: none"> • Laser Scan Micrometers • Litematic • Linear gage counter (EH) • High-Accuracy Digimatic Micrometer (293-100/293-130) 	Picture of Digimatic port				
	Applicable models	<ul style="list-style-type: none"> • Digimatic caliper 500-776/500-777, etc. 500-712-20/500-713-20, etc. 500-712 etc. 550-301-10/550-331-10, etc. 551-301-10/551-331-10, etc. 552-302-10/552-303-10, etc. 552-150-10/552-151-10, etc. 552-155-10/552-156-10, etc. 552-181-10/552-182-10, etc. • Digimatic special application caliper 573-601/573-602, etc. • Digimatic depth gage 571-251-10/571-252-10, etc. • Digimatic scale unit 572-600, 572-601, etc. 	<ul style="list-style-type: none"> • Digimatic micrometer 293-100/293-130 293-140-30/293-141-30, etc. 293-230-30 etc. 340-251-30/340-252-30 • Dedicated micrometers for Digimatic 422-230-30/422-231-30, etc. 406-250-30/406-251-30, etc. 343-250-30/343-251-30, etc. 369-250-30/369-251-30, etc. 345-250-30/345-251-30, etc. 314-251-30/314-252-30, etc. • Digimatic micrometer head 350-251-30/350-261-30, etc. • Digimatic holtest 468-161/468-162, etc. • Digimatic depth gage 329-250-30/329-251-30, etc. 	<ul style="list-style-type: none"> • Digimatic caliper 500-150-30/500-151-30, etc. 500-500-10/500-501-10, etc. 500-443 etc. • Digimatic special application caliper 573-118-10/573-119-10, etc. 573-116-10/573-117-10, etc. 573-191-30/573-291-30 573-181-30/573-182-30, etc. • Digimatic depth gage 571-201-30/571-202-30, etc. • Digimatic micrometer head 164-163/164-164 • Digimatic scale unit 572-203-10/572-213-10 572-300-10/572-301-10, etc. • Digital height master 515-374/515-376, etc. 	<ul style="list-style-type: none"> • Digimatic micrometer 293-582/293-583, etc. 389-514/389-714  <p>Type C straight connectors are available, but may interfere with thimble operation.</p>

(D) Flat 10-pin type	(E) Round 6-pin type	(F) Flat straight type	(FB) Flat L-shape (cable outlet is back)	(FR) Flat L-shape (cable outlet is right)	(FL) Flat L-shape (cable outlet is left)	(G) Flat straight waterproof type
USB-ITN-D 06AFM380D	USB-ITN-E 06AFM380E	USB-ITN-F 06AFM380F	No applicable models USB-ITN-F is available			USB-ITN-G 06AFM380G
(D) Flat 10-pin type	(E) Round 6-pin type	(F) Flat straight type	(FB) Flat L-shape (cable outlet is back)	(FR) Flat L-shape (cable outlet is right)	(FL) Flat L-shape (cable outlet is left)	(G) Flat straight waterproof type
936937	937387	905338	905689	905691	905693	21EAA194
965014	965013	905409	905690	905692	905694	21EAA190
(D) Flat 10-pin type	(E) Round 6-pin type	(F) Flat straight type	(FB) Flat L-shape (cable outlet is back)	(FR) Flat L-shape (cable outlet is right)	(FL) Flat L-shape (cable outlet is left)	(G) Flat straight waterproof type
02AZD790D	02AZD790E	02AZD790F	No applicable models Use 02AZD790F or 02AZD140F .			02AZD790G
02AZE140D	02AZE140E	02AZE140F				02AZE140G



(Note 1) ID-F, EB, EC-101D, ID-U, ID-SS, ID-SX are required to use with the USB-ITN.
 (Note 2) USB-ITN, IT-016U, and U-WAVE cannot be used with EF/EH, VL-50-B/50S-B, and SJ-500/SV-2100.

(D) Flat 10-pin type	(E) Round 6-pin type	(F) Flat straight type	(FB) Flat L-shape (cable outlet is back)	(FR) Flat L-shape (cable outlet is right)	(FL) Flat L-shape (cable outlet is left)	(G) Flat straight waterproof type
N/A	N/A	N/A	N/A	N/A	N/A	N/A

<ul style="list-style-type: none"> • Digimatic indicator ID-H ID-F (Note1) • High-precision height gage QM-Height • Mu-checker Digital Mu-checker (using a foot switch) • Laser scan micrometer LSM-9506 • Linear gage counter EF/EH (Note 2) EB (Note 1), EC-101D (Note 1) • Litematic VL-50-B/50S-B (Note 2) • Contour measuring system SJ-210/310/410 SJ-500/SV-2100 (Note 2) • Hardness testing machines HM-210/220 	<ul style="list-style-type: none"> • Digimatic micrometer 293-666/293-667, etc. 227-201 etc. 369-411/369-412, etc.. • Hardness testing machines HM-100 HM-200 HV-100 HR-300/400/500 HH-411 	<ul style="list-style-type: none"> • Digimatic indicator ID-CX, ID-C (Peak-Value Hold Type) (Note1), ID-C (Calculation type), ID-C (Bore Gage Type), ID-U (Note2), ID-SS (Note1), ID-SX (Note1) • Digimatic height gage 192-663-10/192-613-10/570-322/570-227, etc. (Flat L-shape, cable outlet is right) • ABS borematic 568-361/568-362, etc. • Scale unit 572-460/572-560/572-480-10/572-580-10, etc. • Digimatic bore gage 511-501/511-502, etc. • Hardness testing machines HH-300 • Digimatic depth gage Digimatic type (ID-CX) 				<ul style="list-style-type: none"> • Digimatic indicator ID-N ID-B

Measurement Data Management

Convenient data collection tool and quality control software

Digimatic data cable specifications (Dimensions)

Gage connector dimensions

- (A)** (1) 06AFM380A (2) 05CZA624 (1 m)
05CZA625 (2 m) (3) 02AZD790A (Standard)
02AZE140A (FSW)

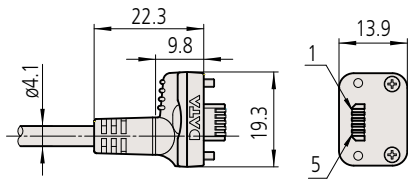

- (E)** (1) 06AFM380E (2) 937387 (1 m)
965013 (2 m) (3) 02AZD790E (Standard)
02AZE140E (FSW)

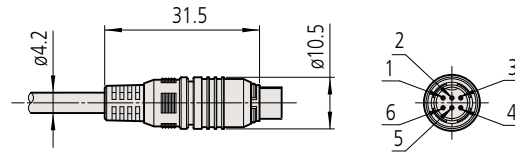

- (B)** (1) 06AFM380B (2) 05CZA662 (1 m)
05CZA663 (2 m) (3) 02AZD790B (Standard)
02AZE140B (FSW)

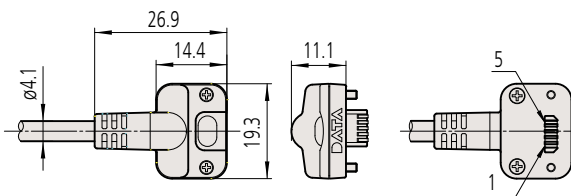

- (F)** (1) 06AFM380F (2) 905338 (1 m)
905409 (2 m) (3) 02AZD790F (Standard)
02AZE140F (FSW)

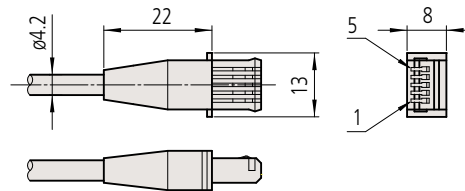

- (C)** (1) 06AFM380C (2) 959149 (1 m)
959150 (2 m) (3) 02AZD790C (Standard)
02AZE140C (FSW)

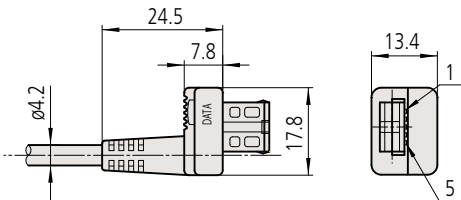

- (FB)** (1) No applicable models (2) 905689 (1 m)
905690 (2 m) (3) No applicable models

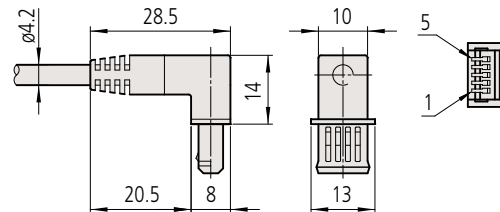

- (CR)** (1) No applicable models (2) 04AZB512 (1 m)
04AZB513 (2 m) (3) No applicable models

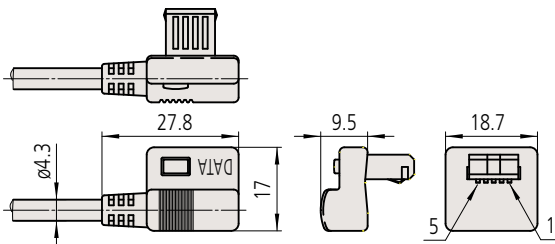

- (FR)** (1) No applicable models (2) 905691 (1 m)
905692 (2 m) (3) No applicable models

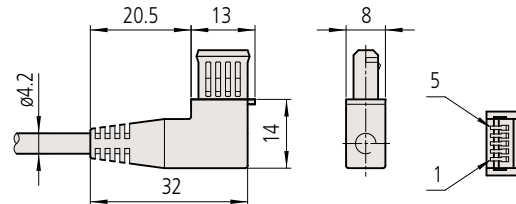

(FL) and (FR) is symmetrical and the same size.

- (D)** (1) 06AFM380D (2) 936937 (1 m)
965014 (2 m) (3) 02AZD790D (Standard)
02AZE140D (FSW)

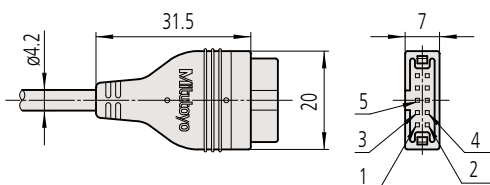

- (G)** (1) 06AFM380G (2) 21EAA194 (1 m)
21EAA190 (2 m) (3) 02AZD790G (Standard)
02AZE140G (FSW)

